

### INSTALLATION:

1a

1b

1

x2  
BEARING

x2  
BB SEAL

x1  
D/S BB  
SPACER\*

x5  
SPINDLE  
SPACER

x1  
FINE TUNE  
SPINDLE  
SPACER

x1  
WAVE  
WASHER

### INSTALLATION:

BB SPACER CHART	SHELL WIDTH	DRIVE SIDE
2a	XC or DH	2.5MM
	CRANKSET	NO SPACER

2

2b

2c Gap / Spacers	
Start with: 0x1	
0.5-1.0mm	
1.0-1.5mm	
1.5-2.0mm	
2.0-2.5mm	

Gap should not exceed 2.5mm

Use thin spindle spacer(x1) to fine tune spacing.

- 1) Remove bearing shield spacers from the bearing(1a) and apply grease to flanged bearing(1b). Check number of required BB spacers(2c).
- 2) Press the BB92 bearing and spacer(2c) one at a time into the BB shell using the provided BB92 install tool taking care not to damage the BB cup face(1b). Reinstall bearing shields.
- 3) Install crankset (see e\*thirteen crankset manual) and crankset spindle spacers. Use chart 2c to determine number of spindle spacers needed.

## REMOVAL:

3

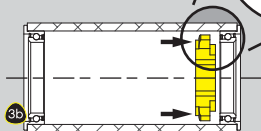
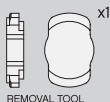

## REMOVAL:

4

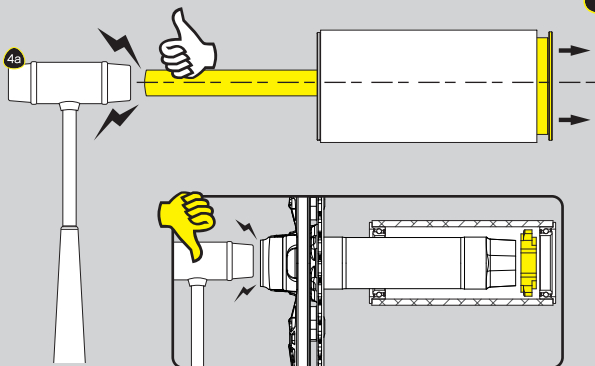

- 1) Remove BB92 bearing shields(3a) and insert BB removal tool(3b).
- 2) Use a punch to remove BB92 bearings from the BB shell(4a). Do not use the spindle as this may damage the polygon interface.